

## Application

The AM-715 is a crankarm kit that includes the crankarm (AM-711) plus an angled plate mounting bracket, two self-tapping screws, and two flat washers. This kit is used to mount the actuator and provide a crankarm for shafts up to 1/2" diameter. This kit can be used with Honeywell Mod IV M6415-type actuators.

## Specifications

- Actuators: MX40-704X.

## AM-715

### Crankarm Kit

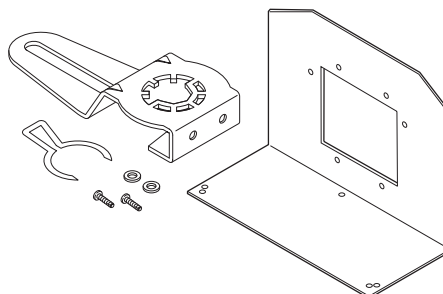

## Application

The AM-717 replacement universal clamp is used to clamp the actuator up to 5/8 in. dia. or up to 1/2 in. sq. Available to replace lost standard clamps shipped with actuator.

## AM-717

### Universal Clamp

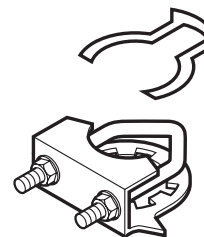

## Application

The AM-720, AM-721, AM-722 and AM-723 auxiliary switches can be added to the DuraDrive MX-6083 and MX-6153 electric actuators. These provide greater control of the actuator movement. Typical applications include control and feedback for the MX40-6083 and MX40-6153 non-spring return actuators for damper control. This includes air handling units, unit ventilators, and inlet guide valves.

## AM-720, AM-721, AM-722, AM-723

### Auxiliary Switches

## Specifications

- Actuators: MX40-6083, MX40-6153.
- Power requirements: 24 Vac, 50/60 Hz, 2 Watts, 6 VA.
- Connections: 3 ft. (1m) 18 AWG color-coded appliance cable.
- Ambient temperature limits:
  - Shipping and storage: -40 to 176°F (-40 to 80°C)
  - Operating: 20 to 131°F (-7 to 55°C).
- Location: NEMA 2 (IEC IP54).

