

MLG-WCT SERIES

SPLIT CORE CURRENT TRANSFORMERS – mV OUTPUT

DTS
SERIES

✓ COMPATIBLE

FEATURES

- Output 0.333Vac at rated current (1Vac or 2Vac optional)
- UL 2808, ANSI C57.13, CE Mark, IEC61010-1, CSA C22.2 61010-1-12
- 600Vac, BIL 10kV AC Full wave
- Arrow points towards load
- 6ft (1.6m) 18AWG black/white twisted UL1015 105°C 600V (longer available on request)
- Typical Accuracy $\pm 0.5\%$ from 10 – 120% of rated current (see table below)
- Designed and Manufactured in the USA. Complies with the Buy American Provisions of ARRA Section 1605.
- Other rated currents and outputs available on request
- Rigid plastic housing – UL94-V0, CAT III
- -15°C to 80°C (90% rel. humidity) operating temperature
- Secured latch
- White (X1 - Hi), Black (X2 - Lo)

DIMENSIONS*

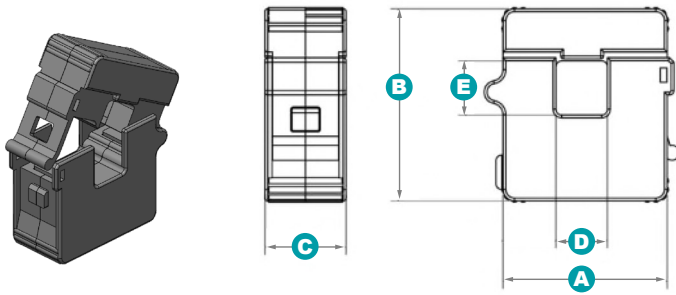

MLG-WCT-0470-XXX: 333							
Rated Current	Dimensions (inches)					Weight	Accuracy
XXX (Amps)	A	B	C	D	E	(lbs)	(%)
010	1.44	1.68	0.71	0.45	0.47	0.12	0.3
020							
025							
030							
050							
060							

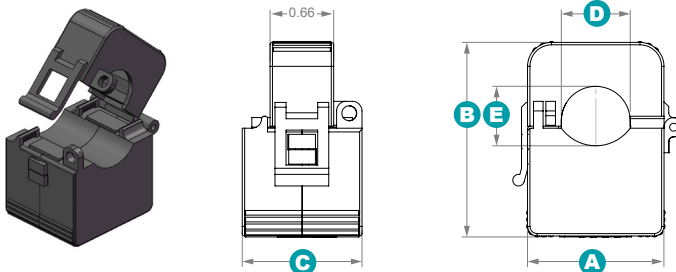

MLG-WCT-0620-XXX: 333							
Rated Current	Dimensions (inches)					Weight	Accuracy
XXX (Amps)	A	B	C	D	E	(lbs)	(%)
025	1.42	2.03	1.25	0.72	0.62	0.35	0.5
030							
050							
060							
080							
100							

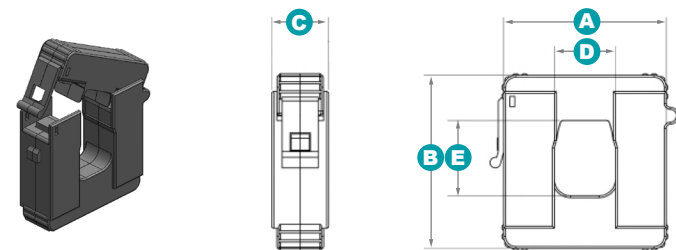

MLG-WCT-0960-XXX: 333							
Rated Current	Dimensions (inches)					Weight	Accuracy
XXX (Amps)	A	B	C	D	E	(lbs)	(%)
060	2	2.13	0.7	0.75	0.93	0.31	0.5
100							
200							

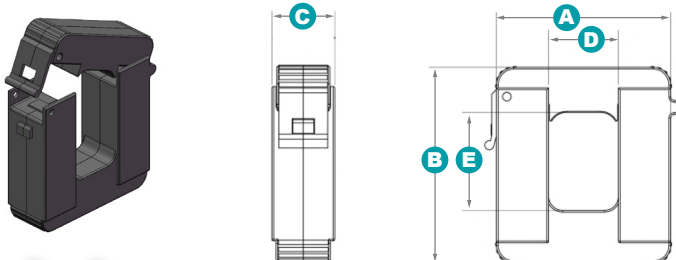

MLG-WCT-1400-XXX: 333							
Rated Current	Dimensions (inches)					Weight	Accuracy
XXX (Amps)	A	B	C	D	E	(lbs)	(%)
100	2.5	2.79	0.9	1	1.4	0.55	0.5
200							
300							
400							

Normally stocked values shown in **BOLD**

DIMENSIONS* (cont.)

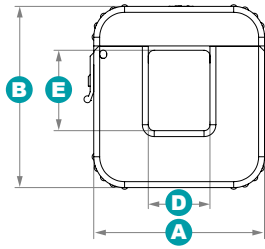
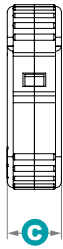

MLG-WCT-1700-XXX: 333

Rated Current	Dimensions (inches)					Weight	Accuracy
XXX (Amps)	A	B	C	D	E	(lbs)	(%)
100	3.6	3.82	1.14	1.3	1.7	1.25	0.5
200							
300							
400							

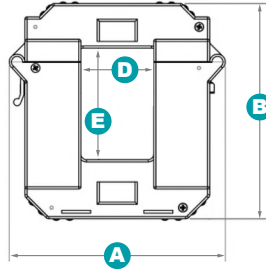
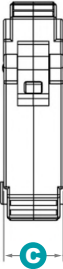
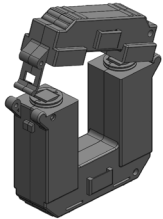

MLG-WCT-2500-XXX: 333

Rated Current	Dimensions (inches)					Weight	Accuracy
XXX (Amps)	A	B	C	D	E	(lbs)	(%)
200	4.84	4.83	1.33	1.63	2.5	1.75	0.5
400							
600							
800							

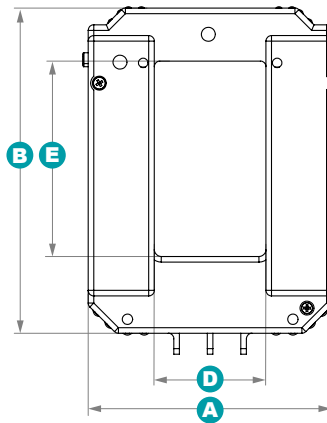
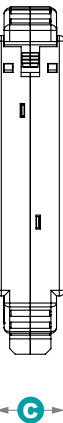
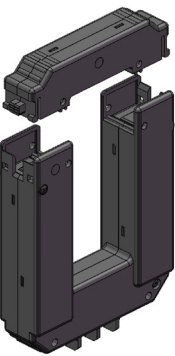

MLG-WCT-3500-XXX: 333

Rated Current	Dimensions (inches)					Weight	Accuracy
XXX (Amps)	A	B	C	D	E	(lbs)	(%)
400	4.37	5.83	1.24	2	3.5	1.85	0.5
600							
800							
1000							

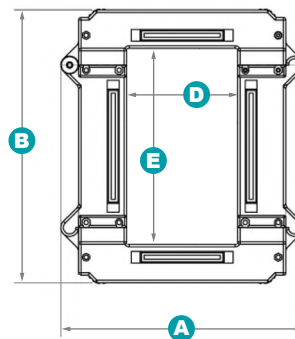
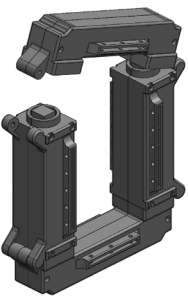

MLG-WCT-5500-XXX: 333

Rated Current	Dimensions (inches)					Weight	Accuracy
XXX (Amps)	A	B	C	D	E	(lbs)	(%)
1200	4.37	7.83	1.24	2	5.5	2.5	0.5
1600							
2000							

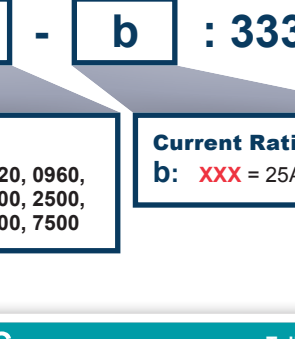
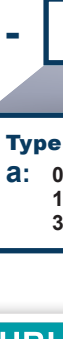

MLG-WCT-7500-XXX: 333

Rated Current	Dimensions (inches)					Weight	Accuracy
XXX (Amps)	A	B	C	D	E	(lbs)	(%)
2000	9.58	10.75	2.9	4.38	7.72	10	0.5
3000							
4000							
5000							

Normally stocked values shown in **BOLD**

MODEL BUILDER & ORDERING EXAMPLES

MLG - WCT - **a** - **b** : 333

Type

a: 0470, 0620, 0960,
1400, 1700, 2500,
3500, 5500, 7500

Current Rating

b: **xxx** = 25A - 5000A

ORDERING EXAMPLES

Part Number	Amps	Aperture
MLG-WCT-0470-050:333	50A : 333mV	0.45" x 0.47"
MLG-WCT-0960-200:333	200A : 333mV	0.75" x 0.93"
MLG-WCT-1700-400:333	400A : 333mV	1.3" x 1.7"

* Drawings are for illustrative purposes only
Technical details subject to change

R22A